

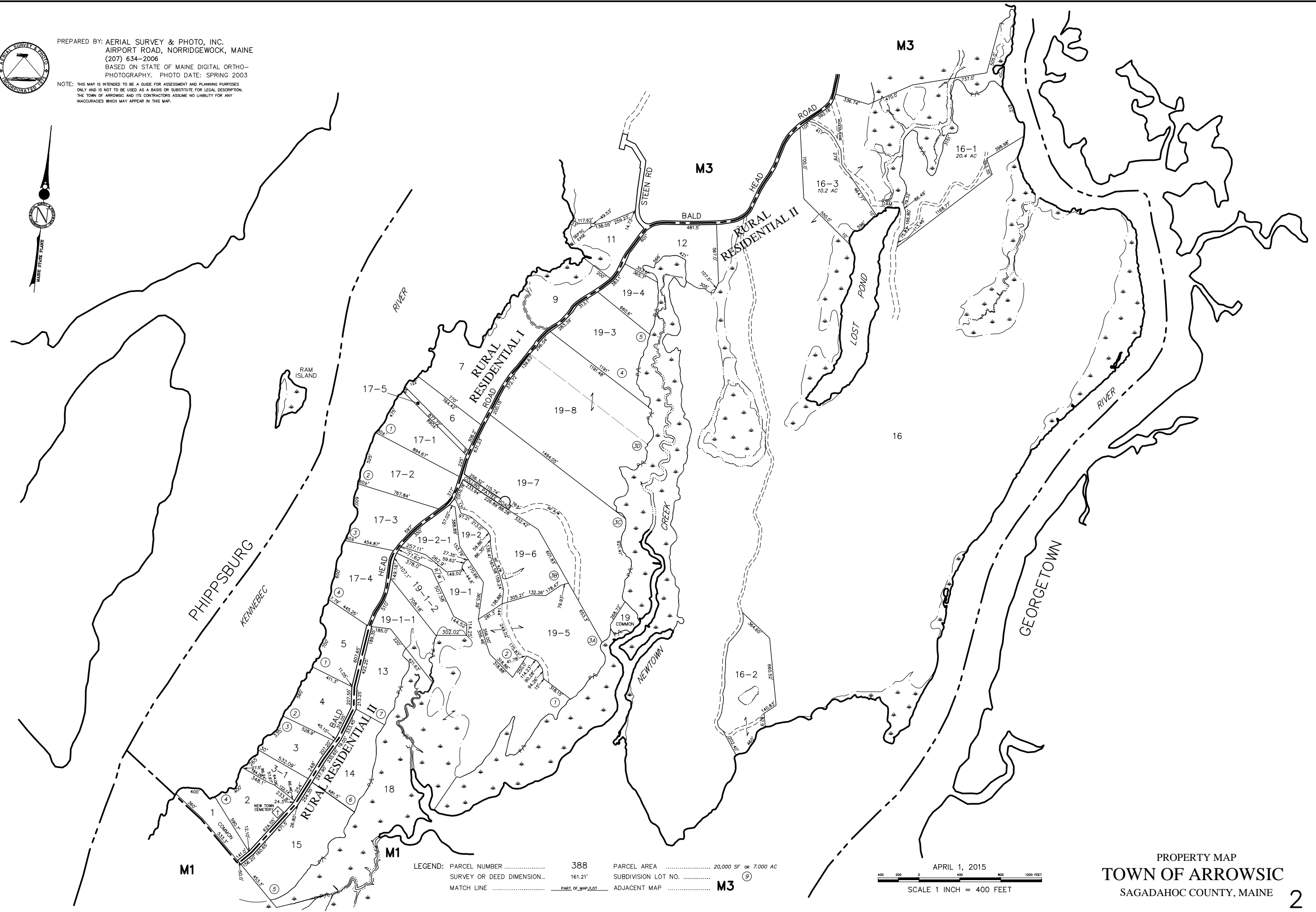

PREPARED BY: AERIAL SURVEY & PHOTO, INC.
 AIRPORT ROAD, NORRIDGEWOCK, MAINE
 (207) 634-2006
 BASED ON STATE OF MAINE DIGITAL ORTHO-
 PHOTOGRAPHY. PHOTO DATE: SPRING 2003

NOTE: THIS MAP IS INTENDED TO BE A GUIDE FOR ASSESSMENT AND PLANNING PURPOSES
 ONLY AND IS NOT TO BE USED AS A BASIS OR SUBSTITUTE FOR LEGAL DESCRIPTION.
 THE TOWN OF ARROWSIC AND ITS CONTRACTORS ASSUME NO LIABILITY FOR ANY
 INACCURACIES WHICH MAY APPEAR IN THIS MAP.



LEGEND: PARCEL NUMBER 388
 SURVEY OR DEED DIMENSION.. 161.21'
 MATCH LINE PART OF MAP/LOT

PARCEL AREA 20,000 SF OR 7,000 AC
 SUBDIVISION LOT NO. M3
 ADJACENT MAP M3

APRIL 1, 2015
 SCALE 1 INCH = 400 FEET

PROPERTY MAP
TOWN OF ARROWSIC
 SAGADAHOC COUNTY, MAINE